

# Installation Instructions 2004 -2020 Toyota Sienna AWD & FWD

**Kit Ordered:** \_\_\_\_\_

**Customer Name:** \_\_\_\_\_

<p><b>AWD 3rd Gen Sienna</b></p> <ul style="list-style-type: none"><li>○ (2) Strut Extensions <b>(no offset)</b></li><li>○ (2) Rear Coil Spring Spacers</li><li>○ (2) Rear Axle Drop Brackets</li><li>○ (2) Sway Bar Links (MOOG)</li><li>○ (2) Rear Bump Stop/Shock Ext.</li><li>○ (2) Camber Adjustment Bolts</li><li>○ (2) Extended Brake Lines</li><li>○ (1) Rear Differential Drop Bracket</li><li>○ (2) 3x3 ABS Blocks</li><li>○ (3) Exhaust Clamps</li><li>○ (1) Exhaust Extension</li><li>○ (1) Exhaust Off Set</li></ul> <p>Hardware Kits</p> <ul style="list-style-type: none"><li>○ Strut Extension Hardware</li><li>○ Rear Axle Drop Bracket Hardware</li><li>○ Rear Differential Drop Hardware</li></ul>	<p><b>FWD 3rd Gen Sienna</b></p> <ul style="list-style-type: none"><li>○ (2) Strut Extensions <b>(no offset)</b></li><li>○ (2) Rear Coil Spring Spacers</li><li>○ (2) Rear Axle Drop Brackets</li><li>○ (2) Sway Bar Links (MOOG)</li><li>○ (2) Rear Bump Stop/Shock Ext.</li><li>○ (2) Camber Adjustment Bolts</li><li>(2) Extended Brake Lines</li><li>(3) Exhaust hanger Extension</li></ul> <p>Hardware Kits</p> <ul style="list-style-type: none"><li>○ Strut Extension Hardware</li><li>○ Rear Axle Drop Bracket Hardware</li></ul>
<p><b>AWD 2nd Gen Sienna</b></p> <ul style="list-style-type: none"><li>○ (2) Strut Extensions <b>(OFFSET)</b></li><li>○ (2) Rear Coil Spring Spacers</li><li>○ (2) Rear Axle Drop Brackets</li><li>○ (2) Sway Bar Links (MOOG)</li><li>○ (2) Rear Bump Stop/Shock Ext.</li><li>○ (2) Camber Adjustment Bolts</li><li>○ (2) Extended Brake Lines</li><li>○ (1) Rear Differential Drop Bracket</li><li>○ (2) 3x3 ABS Blocks</li><li>○ (3) Exhaust Clamps</li><li>○ (1) Exhaust Extension</li><li>○ (1) Exhaust Off Set</li></ul> <p>Hardware Kits</p> <ul style="list-style-type: none"><li>○ Strut Extension Hardware</li><li>○ Rear Axle Drop Bracket Hardware</li><li>○ Rear Differential Drop Hardware</li></ul>	<p><b>FWD 2nd Gen Sienna</b></p> <ul style="list-style-type: none"><li>○ (2) Strut Extensions <b>(OFFSET)</b></li><li>○ (2) Rear Coil Spring Spacers</li><li>○ (2) Rear Axle Drop Brackets</li><li>○ (2) Sway Bar Links (MOOG)</li><li>○ (2) Rear Bump Stop/Shock Ext.</li><li>○ (2) Camber Adjustment Bolts</li><li>○ (2) Extended Brake Lines</li><li>○ (3) Exhaust Hanger Extensions</li></ul> <p>Hardware Kits</p> <ul style="list-style-type: none"><li>○ Strut Extension Hardware</li><li>○ Rear Axle Drop Bracket Hardware</li></ul>
<p>PACKED BY: _____</p> <p>DATE: _____</p>	

# Installation Instructions 2004 -2020 Toyota Sienna AWD & FWD

## Front Lift

You must remove the cowl and wiper motor assembly before you can get access to the strut mount nuts that hold the strut to the strut tower. The wiper blades are press fit, so you may need battery/wiper removal tool to get them off. Be sure to mark the wiper arms and posts so you know how they are aligned when you put them back on. Remove the wiper arm nut caps, unfasten the nuts and remove the wiper arms. Remove the hood to cowl top seal and the cowl panel hole cover. Remove the clip and cowl top ventilator louver, disconnect the washer hose from the louver. Remove the washer nozzle from the cowl top ventilator louver. Remove the washer nozzle from the cowl top ventilator louver. Remove the cowl panel and unplug the wiper motor connector. Unfasten the bolts and remove the wiper motor and link assembly.

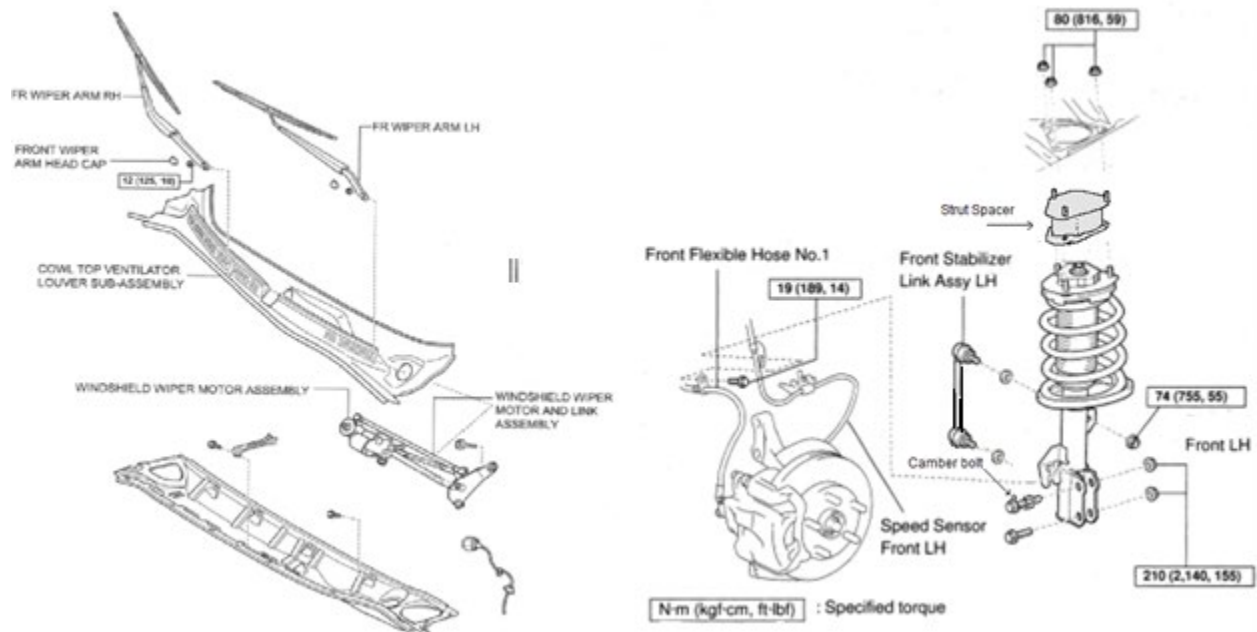

With the vehicle Safely on jack stands, remove the front wheels, sway bar links, brake hose and anti-lock brake cable from the housing. They are just fitted into notches. Remove the caliper and router loosen the strut clamp bolts and nuts from the spindle. The brake hose will still be attached to the caliper, do not let them hang by the hose. Support the lower control arm at the bottom with a jack. Take off the 3 nuts on the top of the strut mount, (**do not** remove the large nut on top of the strut) and slowly lower the strut from the top of the tower. Then remove the strut, with the strut removed install the strut spacer on the strut. Reassemble with the camber bolt in the top hole and replace the sway bar end links with the shorter links supplied in the kit. Both studs aim at tires. An alignment is required.

# Installation Instructions 2004 -2020 Toyota Sienna AWD & FWD

## Toyota Sienna Rear Axle Assy.

4WD DRIVE TYPE:

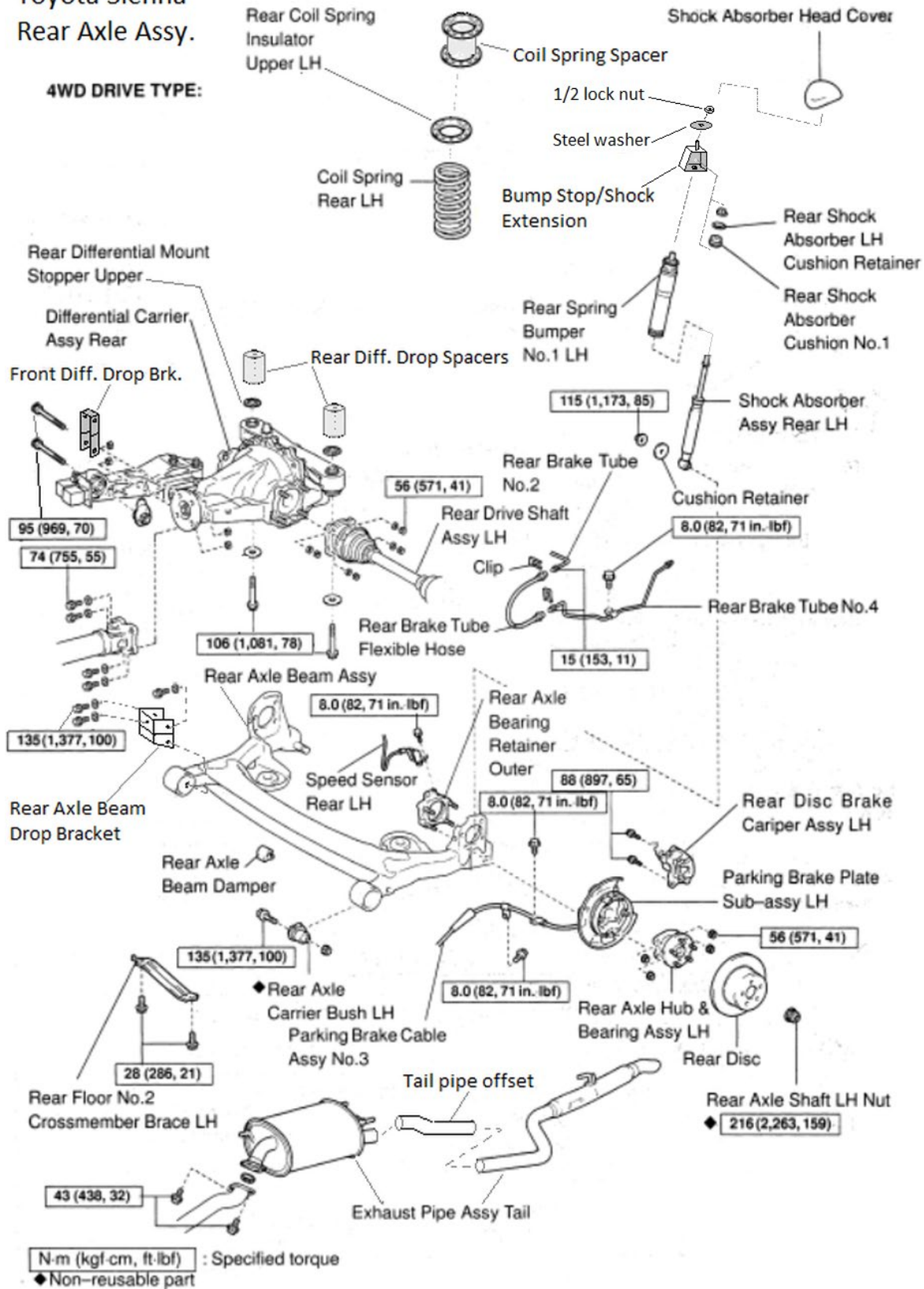

# Installation Instructions 2004 -2020 Toyota Sienna AWD & FWD

## Rear Lift

Remove the rear wheels. On the AWD vans, unbolt the axles and driveshaft from the rear differential and then remove the differential from the van. Remove the ABS speed sensor from the axle or body end. Disconnect parking brake cables from the body. Remove and discard rear brake flexible hose from axle and body. On the AWD models, with a Sawsall, measure 2"/50mm back from the muffler and cut 10"/250.4mm out of the tailpipe. With a floor jack under coil springs, remove shock absorbers. Lower the axle beam to allow the coil springs to be removed. Loosen both but only remove one axle beam bushing bolt at a time, lower axle beam and cut 1/4"/6.26mm clearance for axle beam drop bracket, then install bracket with the three bolts supplied with the kit and torque to 104 lbs/150 Nm. Mount axle beam into drop bracket and insert axle beam bushing bolt, do not torque down until van is on the ground. then install axle drop bracket on other side. With both axle beam drop brackets installed, place coil spring spacers on top of the coil springs, with the shock/bump stop extensions installed on the shocks. Jack up axle beam under spring and install shocks. install differential using longer bolts, spacers and drop brackets. install axles and drive shaft. Install longer brake hoses and bleed rear brakes. Unbolt the parking brake cable clamps from the axle beam and connect cables to body and adjust. Install ABS speed sensor and tail pipe offset.

**On 2WD/FWD vans, do not cut the Exhaust. Use the rubber hangers to drop the muffler down.**

See installation photos at; <https://www.journeysoffroad.com/sienna-lift-kit-installation-instructions.html>

Use extreme caution when lifting and lowering. You may need to go from end to end, lifting in stages to get the van high enough to install the lift kit.

Only use Jacks and jack stands on level smooth hard surfaces.

# Installation Instructions 2004 -2020 Toyota Sienna AWD & FWD

4WD

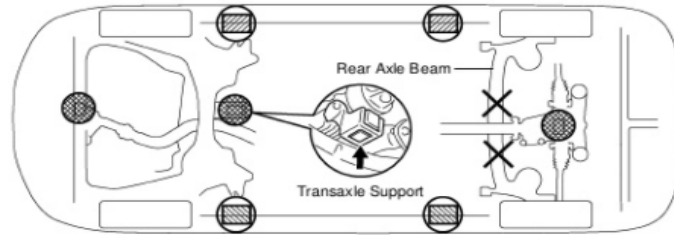

2WD

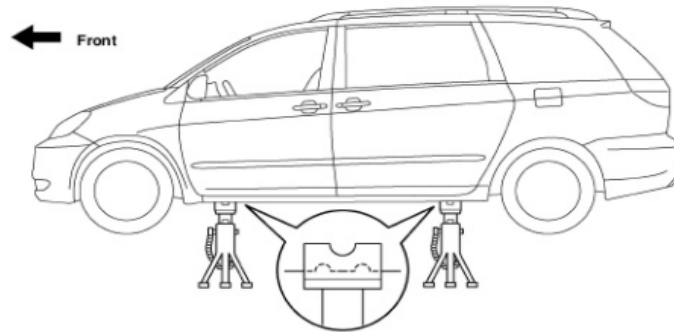
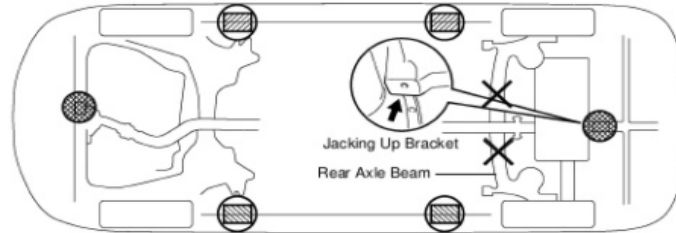

JACK POSITION

Front - - - - - Front suspension member  
Rear - - - - - Jacking up bracket

CAUTION : When jacking up the front and rear, make sure the vehicle is not carrying any extra weight.

NOTICE : Do not jack up at the center of the rear axle beam. If the vehicle is lifted at the center of the rear axle beam, the rear axle beam will be damaged.

PANTOGRAPH JACK POSITION

**Call our Tech Line for help on the installation, 7 days, 7am to 7pm AZ time at 928-925-2360**

RECOMMENDATION: THIS KIT SHOULD BE INSTALLED BY A PROFESSIONAL MECHANIC.

**WARNING:** This vehicle now has been modified to enhance its performance. The steering, braking and handling of this vehicle may differ from standard passenger cars and trucks. This vehicle may also handle differently from an ordinary vehicle in driving conditions which may occur on streets, highways and off road. Avoid unnecessary abrupt maneuvers, sudden stops, sharp turns and other driving conditions that could cause loss of control, possibly leading to a roll over or other accident that could result in serious injury or death to driver and passengers. If larger tires are installed the speedometer will read lower than the vehicles actual speed.

**WARRANTY:** Journeys Off Road lift kits are warranted from manufacturers defects for the life of the vehicle. Warranty does not cover damage to the lift kit due to improper installation or use. Warranty issues will consist of replacement of the defect parts only and do not cover any labor costs or any other costs that were incurred. **DISCLAIMER:** Due to the inherent danger of modifying any vehicle from its stock configuration, Journeys Off Road is not responsible or liable for any damage to vehicle, property or persons when products is being installed, removed or in use.